



Ocean Coral Water Bottle Holder Crochet Pattern

by Concrete Gems Crochet
An easy level crochet pattern
US Terminology



Let the calm of the ocean flow through your stitches with the Ocean Coral Water Bottle Holder – a design inspired by the soft curves of rolling waves and the delicate textures of coral beneath the surface.

This quick, textured project is both beautiful and practical, adding a handmade touch to something you use every day. Suitable for confident beginners and beyond, it's a simple, satisfying make that brings a little hint of seaside serenity wherever you go.

Yarn

Dilly Dally yarn, 70% Pima Cotton, 20% Bamboo, 10% Hemp (100m/109yds, 50g/1.76oz)



Scan the QR code to watch a video tutorial of the pattern.

<https://youtu.be/bcnFaosmaeA>

Other Supplies

4.0mm Crochet Hooks or hook needed to match gauge.

A tapestry needle for working in ends

Scissors

Stitch markers

This pattern is written in US terminology

Tension

Work the base of the Water Bottle Holder to Round 5 to measure 3.5 inches (9cm) diameter.

Yarn Amounts

You will need between 100 and 150 yds of yarn to crochet your holder depending on strap length. This is 1 to 2 balls of the recommended yarn.

Size

The Water Bottle Holder measures: 3.5 inches (9cm) diameter by 10 inches (25cm) in height, with a strap length of 12 (24) inches (30 (61)cm).

Disclosure: This post may contain affiliate links. This means we may receive a commission if you click a link and make a purchase. However, this does not influence our product recommendations, which are based on honest reviews and genuine enthusiasm. Read my [Privacy Policy](#) for more information.

Gallery



Abbreviations

ch(s) - chain(s)
ch-sp - chain space
hdc - half double crochet
hdc3L - half double crochet in the third loop
MR - magic ring
rep - repeat
RS - right side
sc - single crochet
sk - skip
slst - slip stitch
st(s) - stitch(es)
WS - wrong side
[...] - stitch count
* - repeat the instructions from * around

Yarn Alternatives

This pattern is designed to be used with DK weight cotton blend yarn: Dilly Dally is a breathable, soft DK that's also super durable. Any cotton or cotton blend DK would work well for this project.

Here are a few alternative options:

Sirdar Stories, 60% Cotton 40% Acrylic, (50g/1.76oz, 140m/153yds)

King Cole Bamboo Cotton DK, 50% Cotton 50% Bamboo, (100g/3.5oz, 230m/252yds)

Stylecraft Naturals Bamboo Cotton DK, 60% Bamboo, 40% Cotton, (100g/3.5oz, 250m/273yds)

Customisations

You can easily customise the size of your water bottle holder, but bear in mind that any customisations will alter how much yarn you need.

WIDTH: To change the width, work more increase rounds of the base adding an additional 8 stitches to each round.

LENGTH: To change the length, continue working repeats of the set pattern until you are happy. Remember that once a water bottle is added, you will get some stretch.

STRAP LENGTH: To change the length of the strap, continue working rows of the strap until you reach your desired length. The strap will also stretch when a water bottle is added.

Special Stitches

Magic Ring (MR)

[Watch a YouTube tutorial here](#)

The magic ring is a fantastic way to start crocheting in amigurumi, and any crochet in the round. It can be a bit complicated though, so do check out my YouTube tutorial above for a visual guide.

1. Lay the tail end of the yarn over your palm and wrap the ball end around your first 2 fingers. Cross the yarn over and hold that point with your thumb and forefinger.
2. Pull the loop off your fingers, insert your hook into the hole and grab the ball end of the yarn with your hook.
3. Pull the yarn back through the loop. At this point, readjust your hand so you are holding the yarn as you normally would.
4. Put your middle finger and ring finger into the loop to hold it. Then yarn over and pull through to secure your ring.

You can then start crocheting into the ring in the normal way.

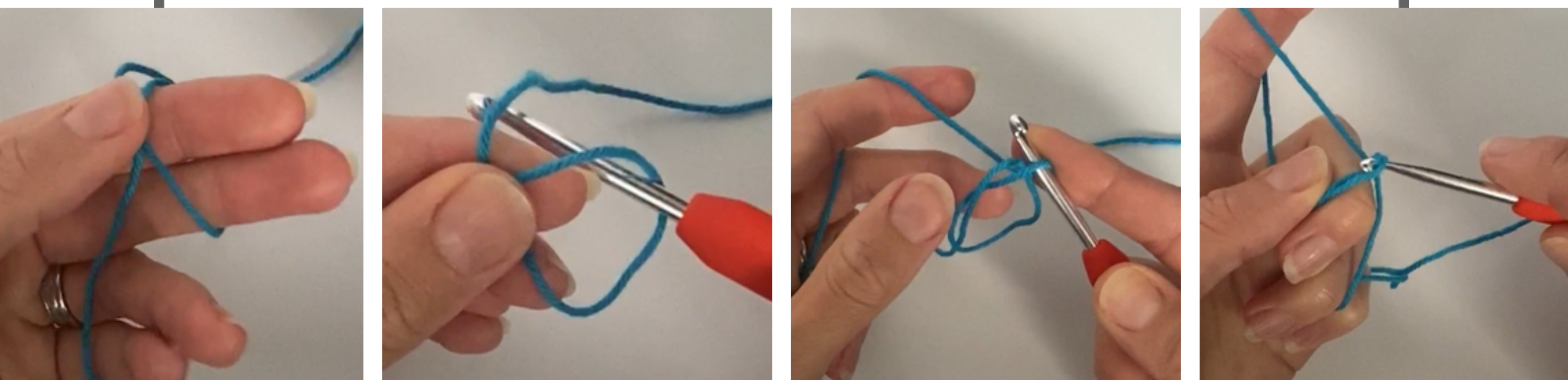

Half double crochet (hdc)

[Learn the half double crochet with me](#)

1. Yarn over and insert hook into stitch.
2. Yarn over and pull through a loop.
3. Yarn over and pull through all 3 loops on your hook.

hdc3L

[Watch a YouTube tutorial here](#)

The hdc3L is worked in the same way as a normal hdc, except that we are working into the third loop created by the hdc from the row below.

1. Locate the third loop on the side closest to you below the normal 2 loops.
2. Yarn over and insert hook into the third loop.
3. Pull through a loop.
4. Yarn over and pull through all 3 loops on your hook.



Pattern Notes

Read through the pattern completely before starting and refer to the stitch tutorials as needed.

ch2 does not count as a stitch throughout.

The water bottle holder is made in joined rounds. A slst is used at the end of each round to join to the first stitch of the round.

Stitch counts are given in [] at the end of a round. Where there is no stitch count, it is the same as the previous round.

In the images, I used the colours Shoal and Oatmeal in the Dilly Dally. The turquoise bottle holder was made using [Paintbox Cotton DK](#) in Kingfisher Blue.

Pattern

Working in joined rounds, make a MR.

Round 1 (RS): ch2 (does not count as a st here and throughout), 8hdc in MR, slst in first st to join. [8]

Round 2: ch2, 2hdc in each st around, slst in first st to join. [16]

Round 3: ch2, (hdc in next st, 2hdc in next st) rep around, slst in first st to join. [24]

Round 4: ch2, (2hdc in next st, hdc in next 2 sts) rep around, slst in first hdc to join. [32]

Round 5: ch2, (hdc in next 3 sts, 2hdc in next st) rep around, slst in first st to join. [40]

Round 6: ch2, hdc3L in each st around, slst to first hdc3L to join.

Rounds 7-10: Rep Round 6.

Round 11: (ch4, sk 3 sts, sc in next st) rep around, do not slst here but continue to next round. [10 sc and 10 ch4-sps]

Round 12: ch2, (sc in next ch4-sp, ch4) rep around, slst in first sc to join.

Rounds 13-15: Rep Round 12.

Round 16: ch2, hdc in same st, 3hdc in ch4-sp, (hdc in next sc, 3hdc in ch4-sp) rep around, slst in first hdc to join. [40]

Rounds 17-20: Rep Round 6.

Round 21: Rep Round 11.

Rounds 22-25: Rep Round 12.

Pattern

Round 26: Rep Round 16.

Rounds 27-30: Rep Round 6.

Continue to make the strap.

STRAP

Note: there are 2 strap lengths given below as follows: short (long). The short strap is designed to be worn on one shoulder, whilst the long strap is designed to be worn crossbody. Alternatively continue repeating Row 1 until you have your desired strap length.

Row 1: ch2, hdc in next 7 sts only, turn.

Rows 2-60 (120): Rep Row 1.

Fasten off leaving a long tail. Count 13 sts on the main holder from where you fastened off and sew Row 60 to the next 7 sts using the long tail. Take care not to twist the strap.

Fasten off and weave in ends very securely.

Join the Concrete Gems Crochet Community on Facebook!

If you enjoyed making the Ocean Coral Water Bottle Holder crochet pattern, please consider sharing it to social media tagging @concretegemscrochet Find me on socials at the links below:

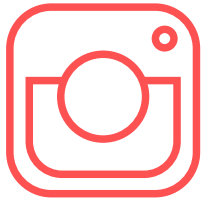

Thanks to my tech editor Shirley Williams.

I've really loved designing this pattern for you and hope you have had fun making it. I'm Gemma, a crochet tech editor, designer and overall crochet enthusiast. I'm also a mum of 3 kids, and enjoy running, reading, walking and crafting, but mostly crochet!



[Sign up to my mailing list for the latest news, pattern releases and special offers here](#)

Follow me on Facebook or Instagram @concretegemscrochet

Find more patterns on my website: concretegems.co.uk

The Ocean Coral Water Bottle Holder crochet pattern is the intellectual property of Concrete Gems. It is strictly prohibited to share, copy, alter, or distribute this pattern in any form.

You are welcome to sell finished items made using this pattern on a small scale, provided you give design credit to @concretegemscrochet. Thank you for respecting the effort and creativity that went into creating this design.

Disclaimer and Safety Notice

This pattern is intended for personal use only. The creator of this pattern is not responsible for any accidents, injuries, or damages resulting from the use of this pattern or the items made from it.

Important Notes:

- **Material Safety:** Ensure that you use materials appropriate for the intended purpose of the finished item. For items intended for children or babies, use child-safe and non-toxic materials, such as certified baby-safe yarns. Avoid small parts that could pose a choking hazard.
- **Finished Item Safety:** If creating items for young children, ensure they meet relevant safety standards (e.g., CE marking in the EU for toys). It is the responsibility of the maker to ensure compliance if selling finished items.
- **Tool Safety:** Exercise caution when using sharp tools such as crochet hooks, scissors, or yarn needles, and keep these tools out of reach of children.
- **Allergies:** Be mindful of potential allergens in yarns and materials, and consider hypoallergenic options when creating items for individuals with sensitivities.

By purchasing this pattern, you agree to these terms and accept responsibility for the safe use of the pattern and any resulting finished items.

Please see pdf labelling for GPSR Compliancy in all EU languages.